



How to make
a bespoke playground:
Guide book

 **LAPPSET**®

How to make a bespoke playground — Guide book

When regular playground is not enough, this book offers you step-to-step guidance how to start designing a custom playground, that is unique in looks, rich in play experience, financially sustainable, and safe to use.

As your Nordic turnkey partner, we take pride in creating unforgettable experiences that offer high play value and encourage repeat visits. At Lappset, we are passionate about play and committed to delivering exceptional family experiences.

We are serious about play!



Table of contents

Activity structure that feels own	4
Our design process	6
Defining budget scope	8
Choosing design language	10
Great Concepts	12
Mammoths in Harwood Park, USA	12
Koi Fish, Australia	22
Cyberpunk Worm, Hong Kong	24
Ornamental Tree, Australia	26
Nordic Crown, Norway	28
Magical Projects	30
Castle in Laune, Finland	30
Lighthouse, France	38
Karingal Hub, Australia	42
Ranua Zoo, Finland	48
Thomas St. Inclusive, Australia	54
Hot Air Balloon, Finland	56
Pirate Ship & Skull Island, Germany	58
Benny's Spaceship, Denmark	62



Activity structure that feels own

With over 50 years of experience, high quality, sustainable materials and playground safety are in the core when bringing unique and playful locations to life.

We provide our customers a turnkey service, where the end result is a co-designed and unique activity structure that feels like own.

You as a designer, investor or operator get to keep your focus on overseeing that every piece in the puzzle fits together in a coherent way.

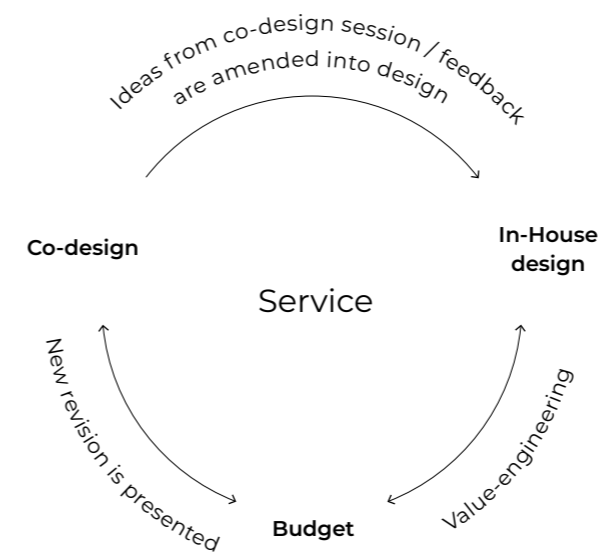

Co-design

Main purpose of co-design is to understand customer needs and amend the design accordingly.

In-House design

In between co-design sessions, the latest ideas are evaluated with engineers and developed further by concept design team.

Budget

In between co-design sessions, the estimated costs are being calculated.



Our design process

Concept design starts with collaborative Co-Design -phase with the customer to set up the concept design principles for the rest of the project.

The whole design phase is conducted with short sprint convention and regular check-up meetings with the customer professionals, and customized and adapted to fit your processes and needs.

Lappset bespoke design & build Process

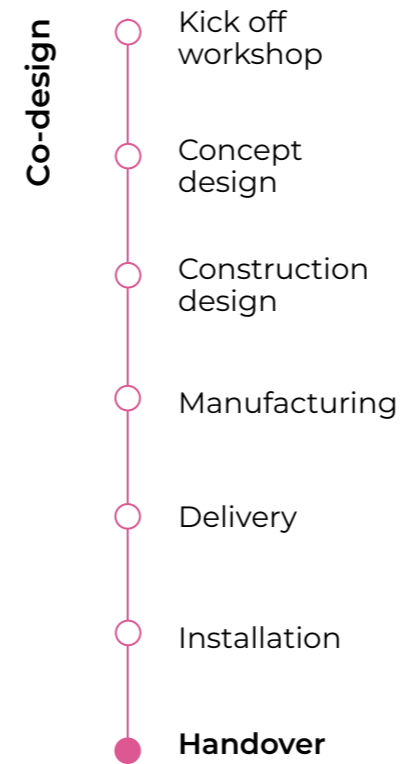

Karingal Hub – Photo by our channel partner Lark Industries, Australia.

Defining budget scope

When it comes to finding the perfect solution for your needs, it's crucial to set clear expectations right from the start. And one essential aspect to consider is your budget scope. Defining your budget early on helps us understand the parameters within which we can work together to create a tailored solution that fits just right!

Remember, a higher budget grants us greater flexibility when it comes to theming elements. With more resources at our disposal, we can explore creative avenues, experiment with new designs, and deliver an exceptional experience that truly stands out.

However, even if you have a smaller budget, worry not! Our expertise lies in maximizing the potential of existing modules. We'll ensure they are utilized in innovative and ingenious ways, transforming your project into something extraordinary.

Low 35 000 € - 150 000 €

What to expect:

- Moderate size (~50 m² - 150 m²)
- Frame from existing modules
- Using existing play functions
- 2D theming

Mid 150 000 € - 350 000 €

What to expect:

- Large size (~150 m² - 500 m²)
- Custom designs in structures and play functions
- Existing module system can be expanded with unique shapes
- 2D and 3D theming

High 350 000 € +

What to expect:

- Landmark size (~350 m² +)
- Custom designs in structures and play functions
- Expanded modular system and/or completely custom frame structures
- 2D and 3D theming

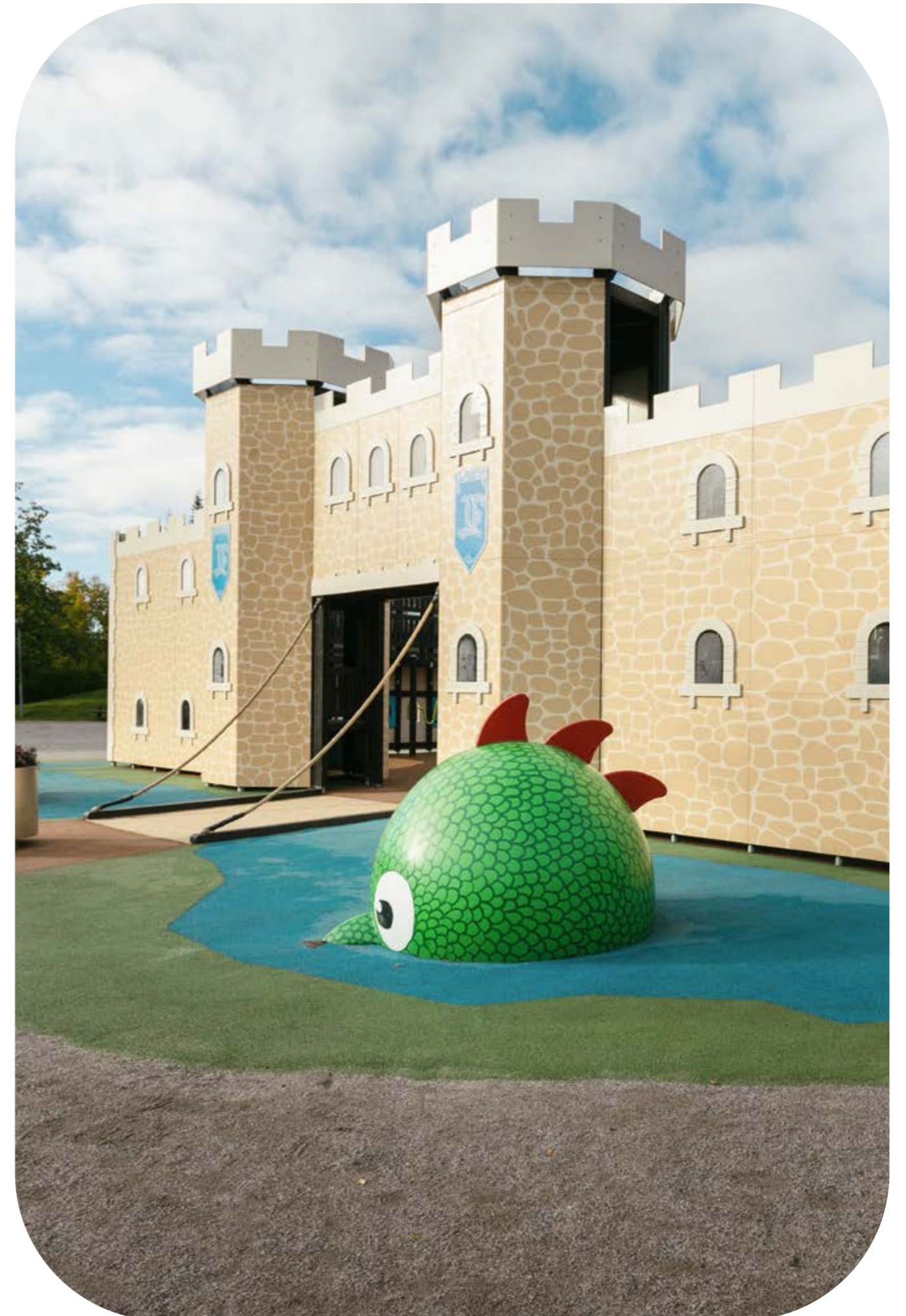



Choosing design language

When it comes to the design direction of your dream project, we believe in getting involved early to ensure a clear and feasible vision right from the start.

We offer two distinct design directions that will ignite your imagination and bring your project to life. The first option is a sculptural and architectural that seamlessly integrates with its environment. Picture a structure that becomes a work of art, either a landmark, or blending harmoniously with its surroundings.

On the other hand, we can start from captivating a story, and making a themed area for those seeking an immersive adventure. Imagine stepping into a world of pirates, where every corner is a new chapter waiting to be explored.



No matter which design direction you choose, we have you covered: our modular building blocks, Nordic pine or steel, provide the perfect foundation, saving you time and effort. You don't have to start from scratch — we'll assist you in crafting a remarkable experience using our tried-and-true elements.

1. Sculptural designs

Architectural and playable landmarks that blend with the surroundings.

2. Themed designs

Story based designs that create their own imaginary world.



Great Concepts

—
Mammoths in
Harwood Park,
USA

Project by our channel partner SPEC.

Mammoth landmark activity structures.



First mock up from sketch by the landscape architect.

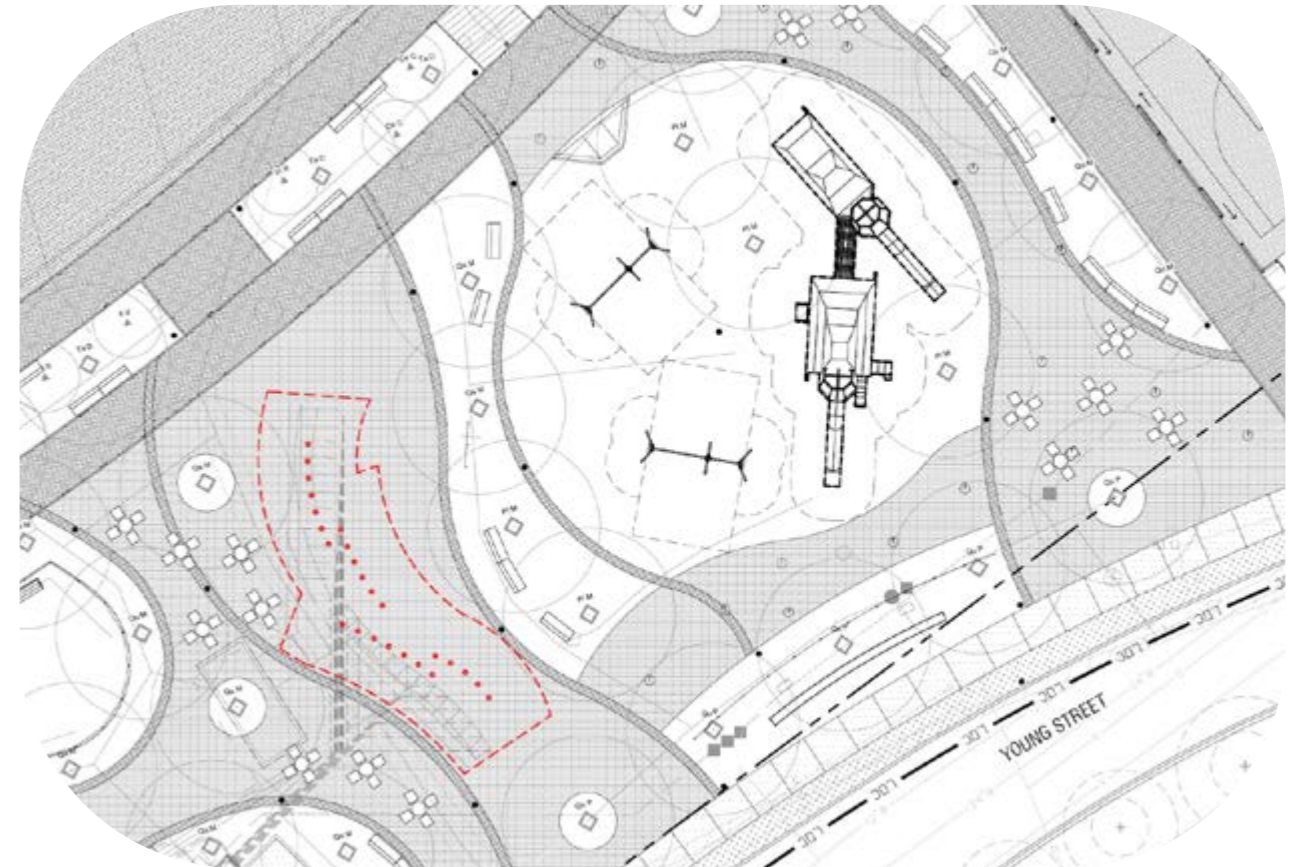

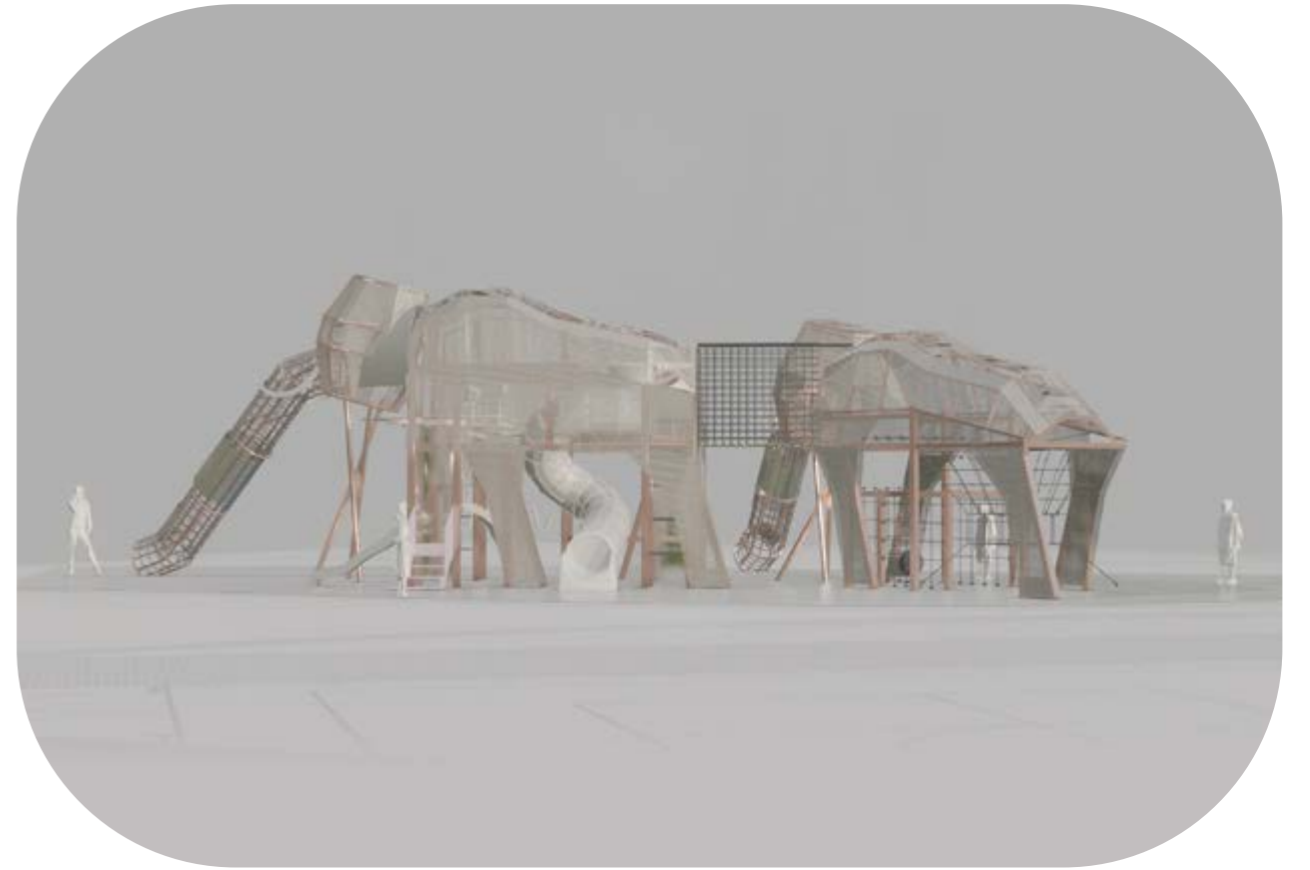



Steel frame covered with metal mesh

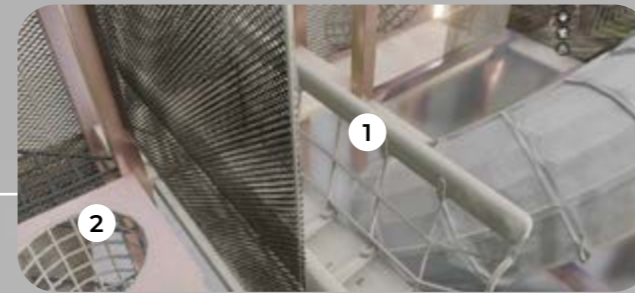

Upper level

- 1. Rope bridge
Nest embedded as part of the structure
- 2. Vertical net climber
Three-dimensional vertical net climber



Trunk crawling climb
Net climbing entry/exit

Tusks

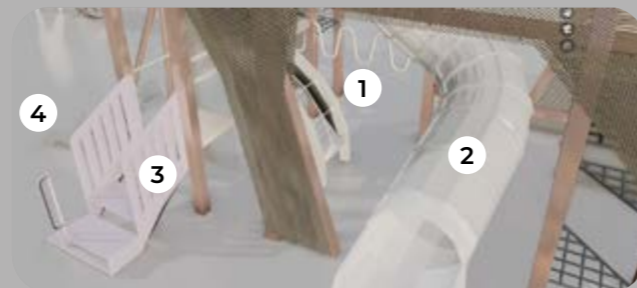

Ground level

- 1. Arcs with net
Climbing transition + play walls and inclusive play elements
- 2. Tube slide
Top-part of the slide can be climbed on top inside the structure.
- 3. Inclusive stairs
Stairs up to small slide
- 4. Low level open slide
For toddlers

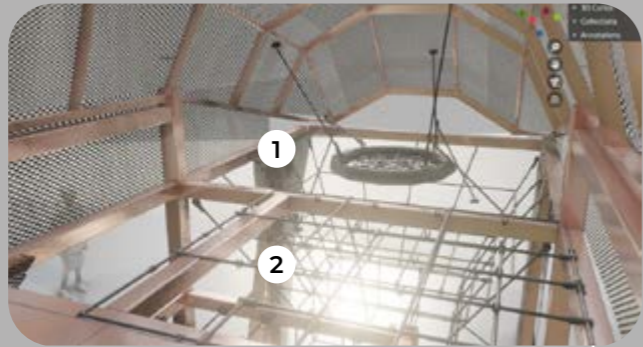

Upper level

- 1. Knitted nest
Nest embedded as part of the structure
- 2. Funnel net
Three-dimensional vertical net climber



Accessible head
Lookout point



Transparent acrylic
/ polycarbonate walls



Ground level

- 1. Cubic net climb
Three-dimensional vertical net climber



Climbable sphere
Plastic sphere, balancing activity



Climbing nets



Koi Fish CONCEPT



Cyberpunk Worm CONCEPT



Ornamental Tree **CONCEPT**



Nordic Crown CONCEPT



Magical Projects
—
Castle
in Laune, Finland

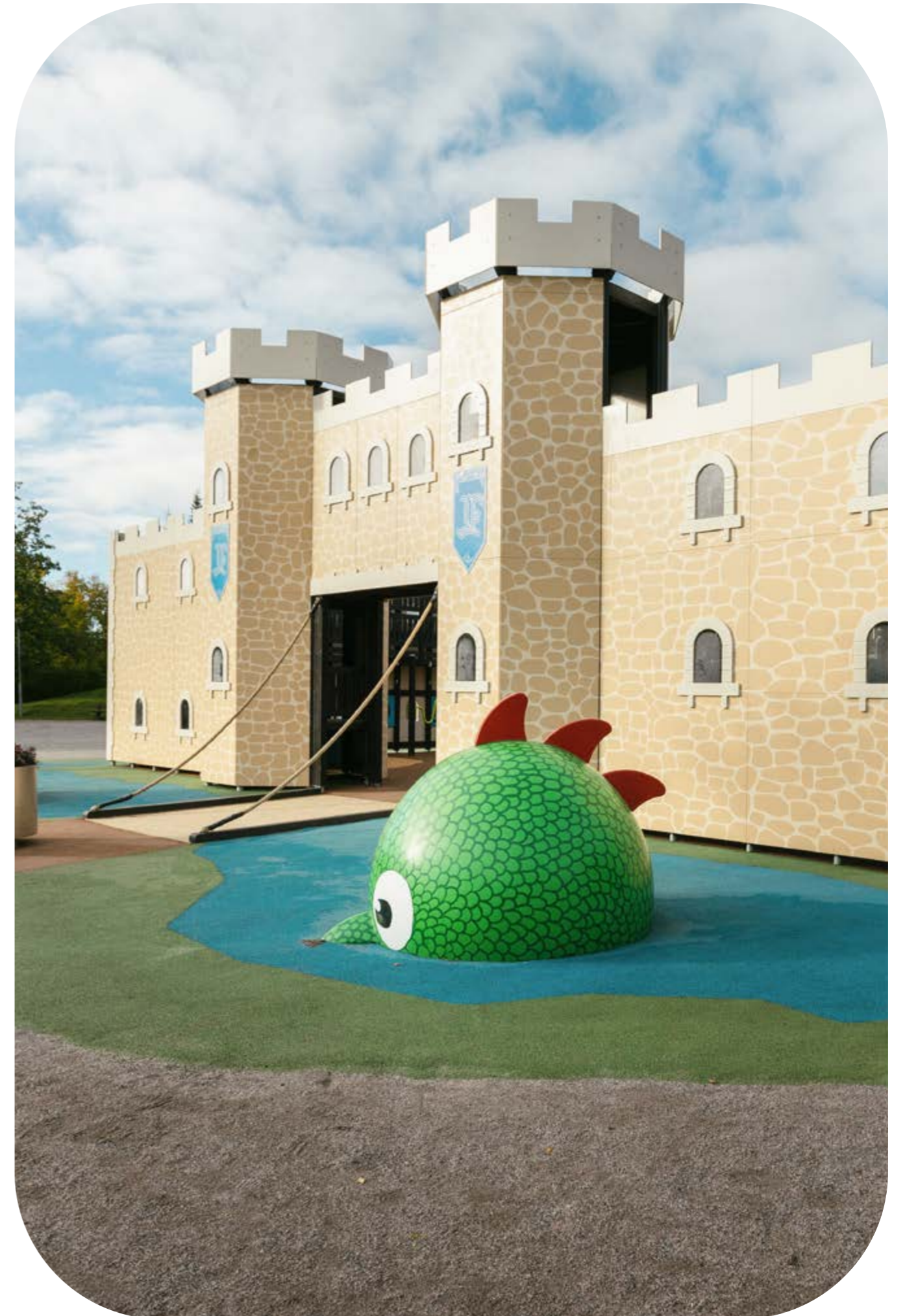









Lighthouse in
Holiday Resort
L'Océan Breton,
France







Karingal Hub in Karingal, Australia

Project and photos by our channel partner Lark Industries.

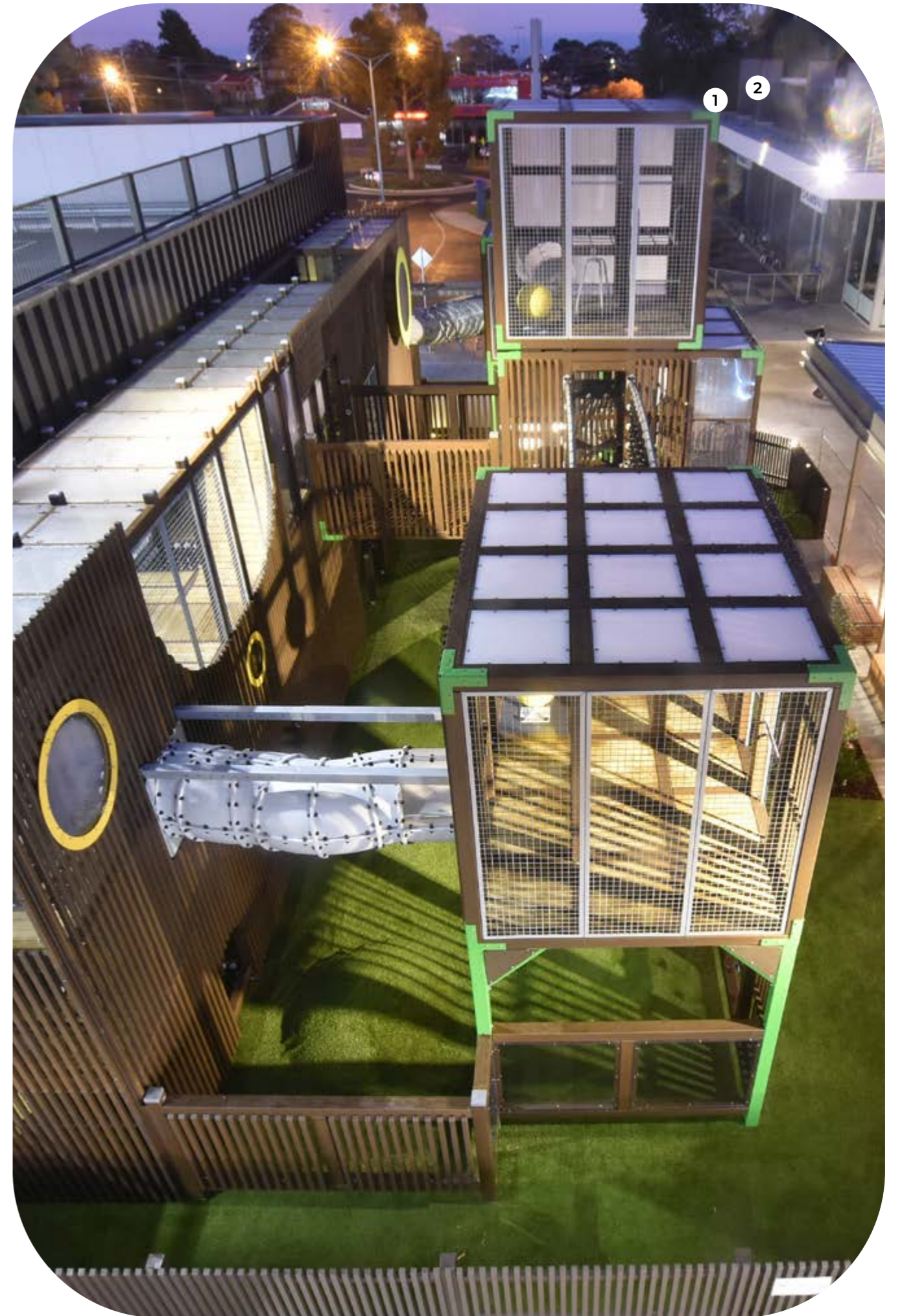

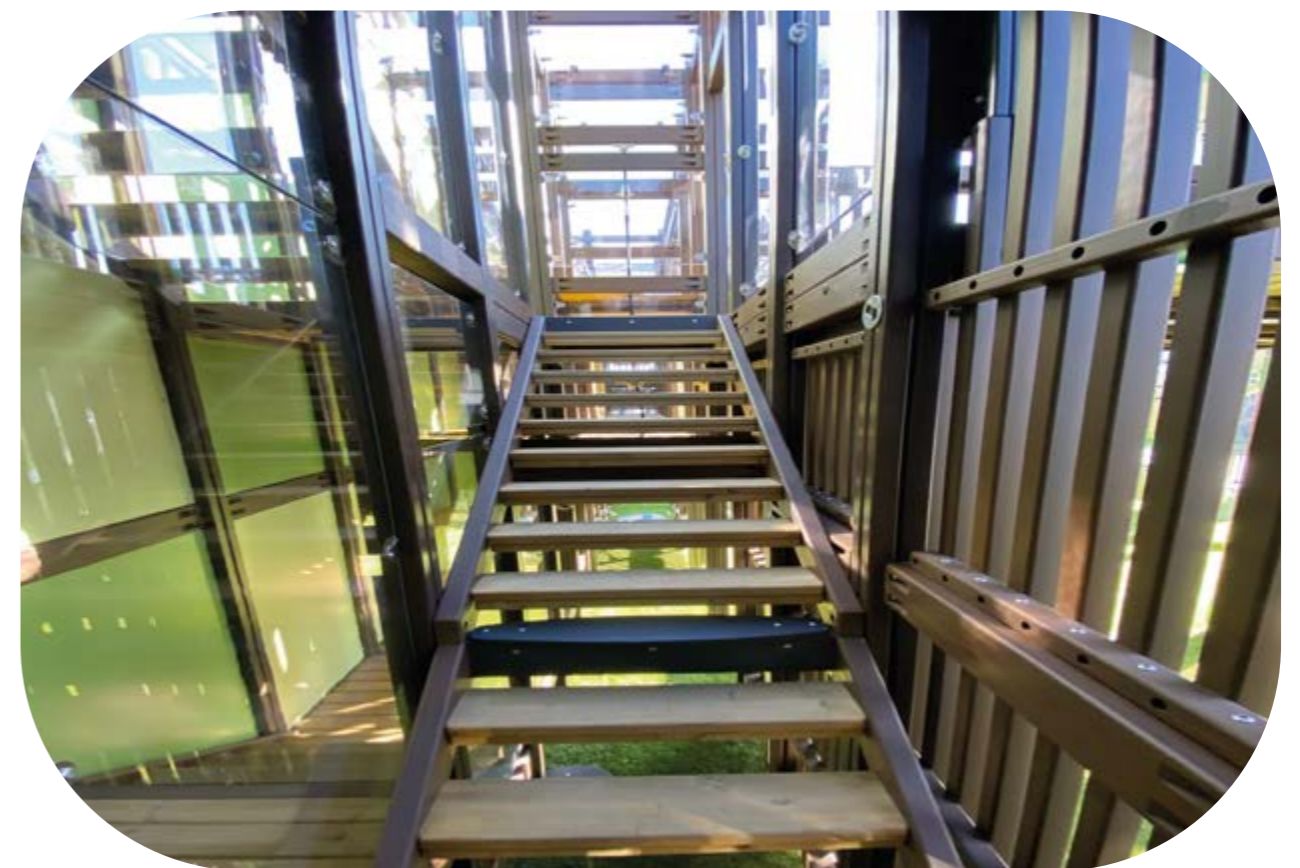

Small footprint, lots to do.

Karingal Hub – Photo by our channel partner Lark Industries, Australia.



Small footprint, lots to do.



Karingal Hub – Photos by our channel partner Lark Industries, Australia.





Ranua Zoo
in Ranua,
Finland

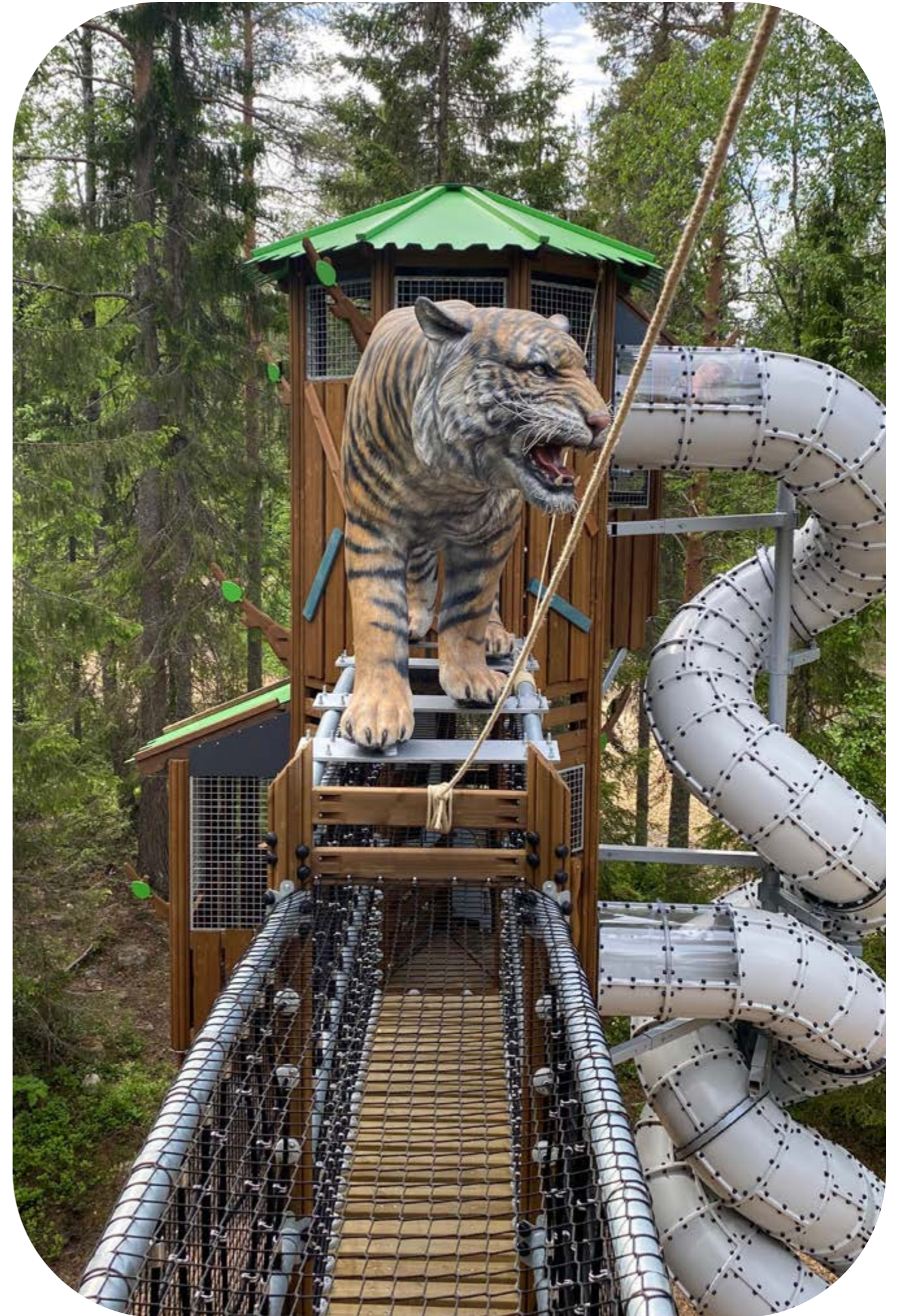







Thomas St. Inclusive Playscape in Victoria, Australia

Project and photos by our channel partner Lark Industries.





Hot Air Balloon
in Kouvola,
Finland

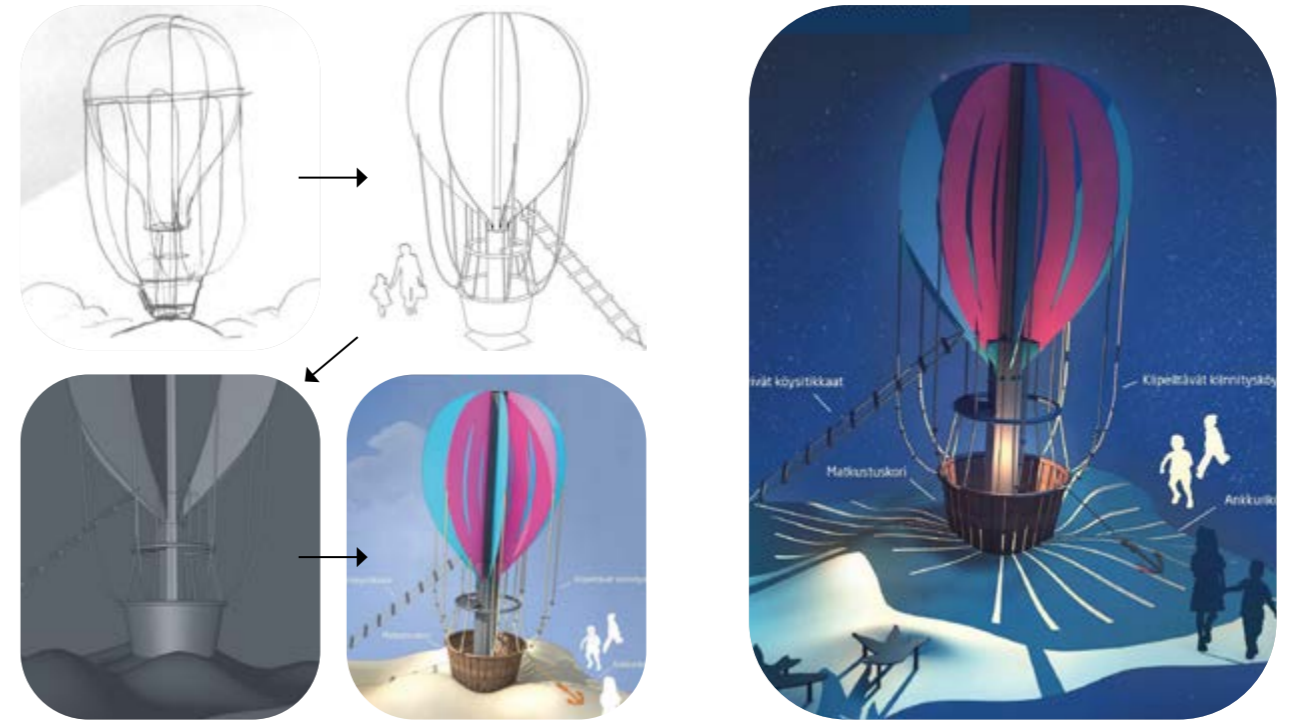

With effect lights during evening hours.

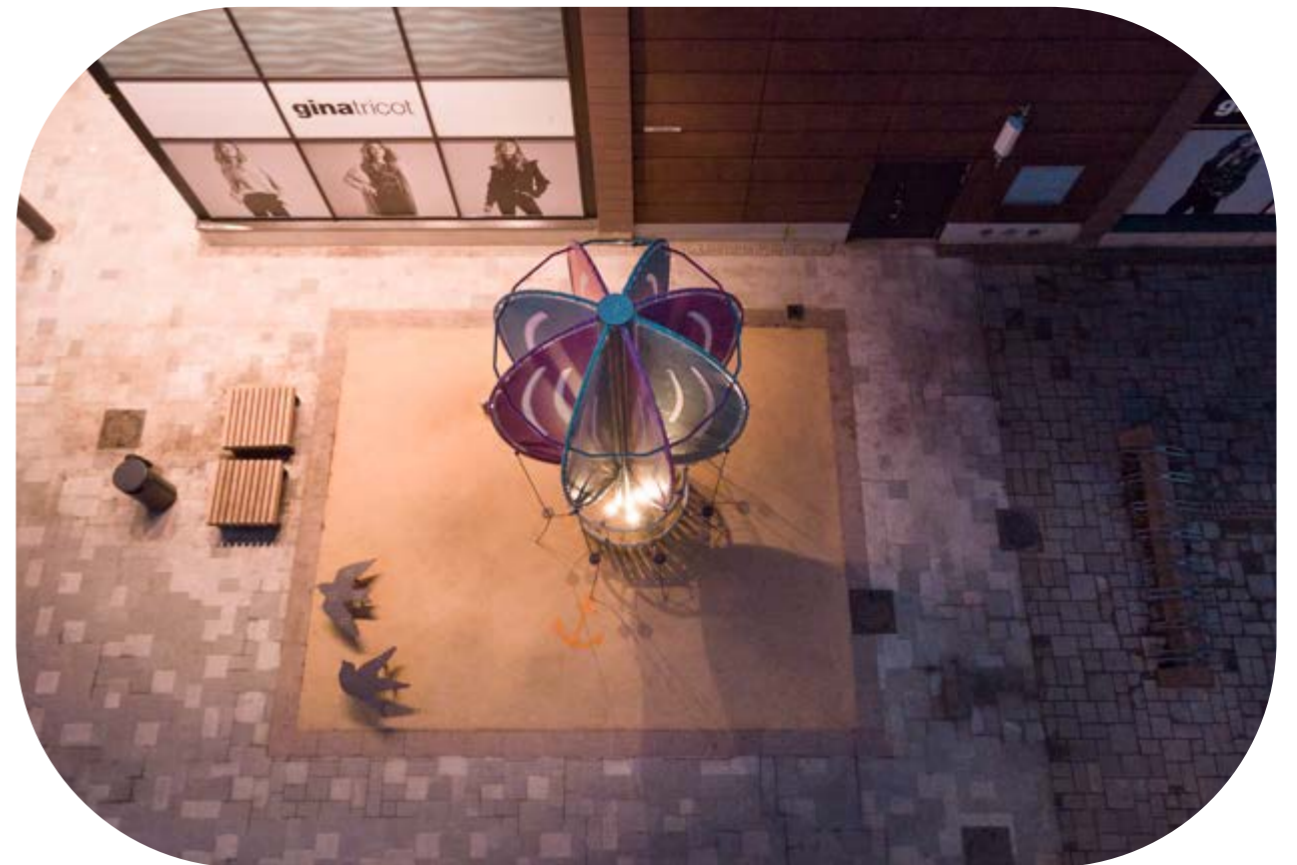



Pirate Ship & Skull Island in Legoland, Germany







Benny's Spaceship
in Legoland Billund,
Denmark





LARK

INDUSTRIES
playup workout

Lark Industries

PO Box 524
Templestowe VIC 3106
www.larkindustries.com.au
info@larkindustries.com.au
1300 156 322



LAPPSET®

We invite mankind outdoors

